

**Operation Manual**  
**mp-1000V(N)**

**ACEBIL**



**[www.acebil.com](http://www.acebil.com)**

# **mp-100V(N)**

## **Monopod Kit**

Copyright © Eagle Beaming International Co. LTD. 2020

All rights reserved. Reproduction of any part of this document including images, artwork, or writing without prior written consent of Eagle Beaming International Co. LTD. in writing is strictly prohibited.

# Contents

<b>Safety.....</b>	<b>3</b>
<b>Technical Specifications.....</b>	<b>3</b>
<b>Components.....</b>	<b>5</b>
<b>Operation</b>	
<b>Setting up the Monopod.....</b>	<b>6</b>
<b>Mounting the Camera.....</b>	<b>7</b>
<b>Further Information.....</b>	<b>8</b>

# Safety



Where there is a risk of injury, or damage to equipment, this warning symbol will appear. This equipment may cause harm if not used in accordance with this operation manual.

## Before operating this equipment, please read manual for safety.

- Always maintain payload to within the maximum capacity limit.
- Ensure quick shoe lock lever is firmly tightend.
- Ensure monood is securely positioned, and all leg locks are in the locked position.
- Do not modify, or dismantle equipment, as it may cause damage, and injury.
- When using pan and tilt features (If Applicable), ensure the lock knobs are fully loosened.
- Always remove camera and accessories before transporting.
- Never carry system by grabbing the pan arm as it may cause damage.

## Technical Specifications

Payload	8kg / 17lb
Counter Balance	Fixed Setting
Pan Drag	Fixed Setting
Tilt Drag	Fixed Setting
Tilt Angle	+90° / -80°
LED Bubble Level Illumination	No
Camera Plate	Slide Plate
Plate Attachment	1/4-20" Screw
Spare Camera Screw	3/8" w/ video pin
Slide Range	+35 / -35 mm
Weight	3.3kg / 7.35lb
Height	91-200cm / 35.8"-78.7"
Ball Diameter	Flat Base
Leg Section	4 Section

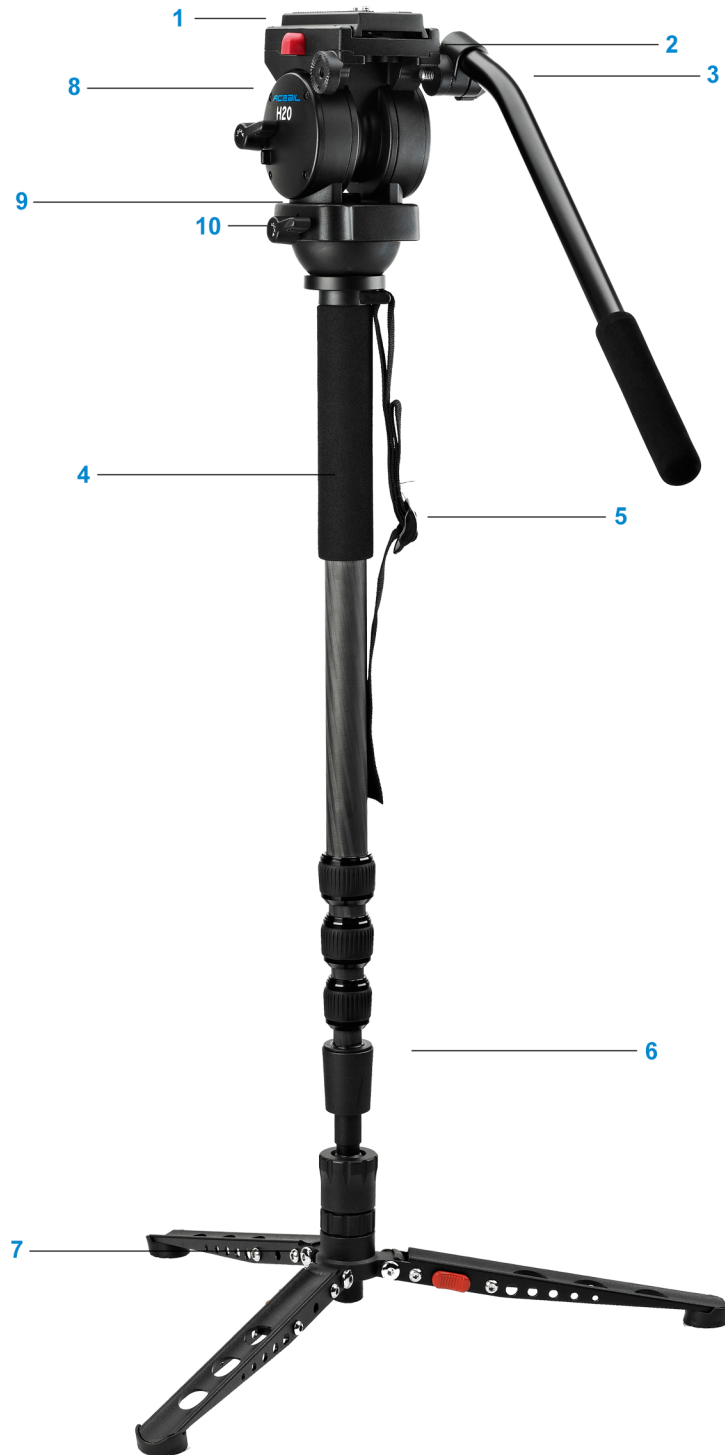

- 1 - Quick Release Plate
- 2 - Quick Release Lock Knob
- 3 - Pan Bar
- 4 - Foam Grip

- 5 - Wrist Strap
- 6 - Leg Locks
- 7 - Floor Spreader
- 8 - Tilt Lock Knob
- 9 - Pan Lock Knob
- 10 - Bubble Level

# Setting up the monopod.

1. Extend Floor Stand Legs, Release monopod leg locks.
2. Extend monopod to desired height.
3. Securely lock monopod leg locks.

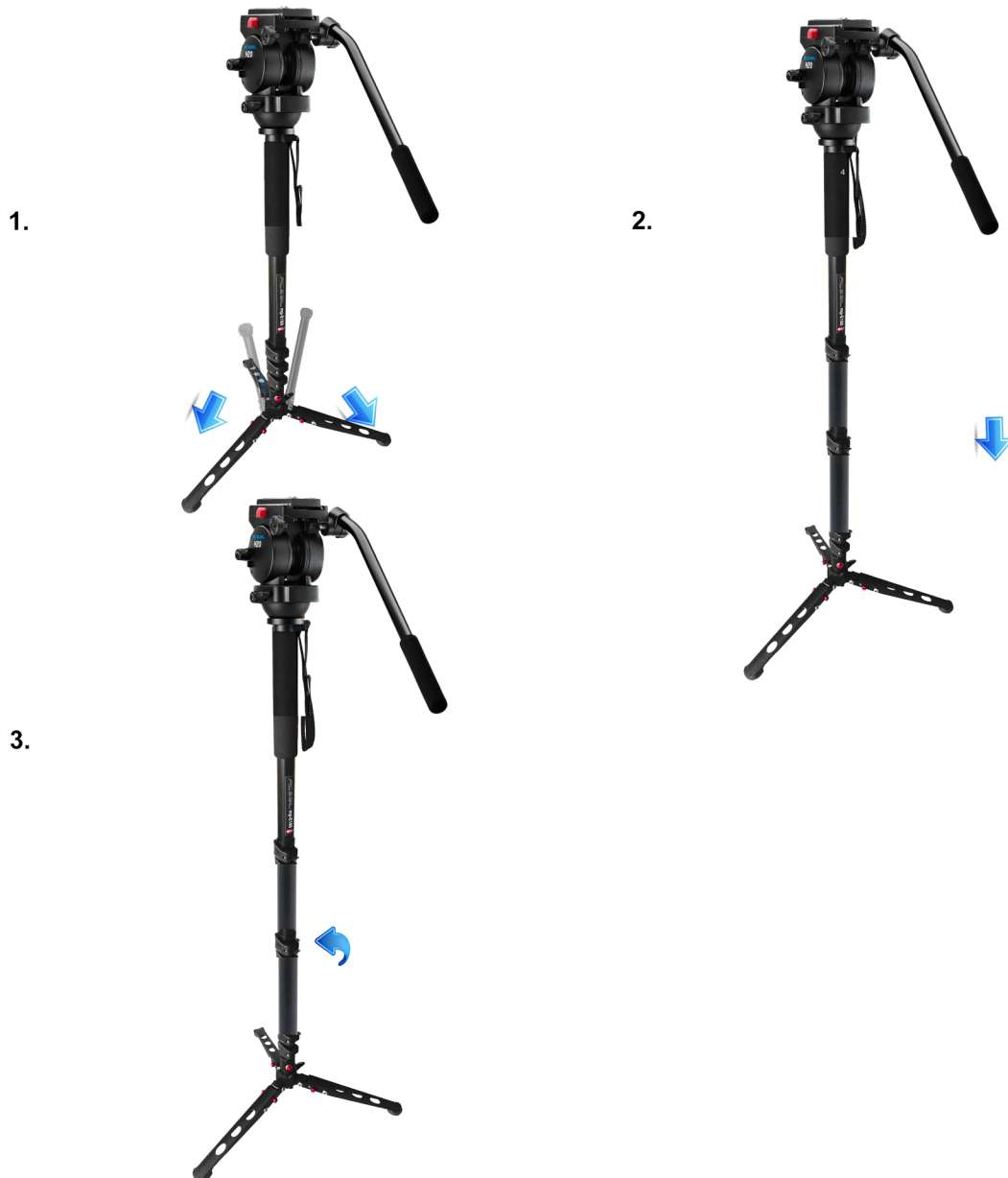

# Mounting the camera.

**Load capacity is 8kg / 17.6lbs. - Do exceed the load capacity as it may cause damage to equipment or injury.**

**When mounting and removing camera, ensure the tilt lock knob is firmly tightened.**

1. Ensure tilt lock knob is tightened.
2. Remove the slide plate.
  - ① Loosen the slide plate lock lever.
  - ② Pull slide plate out.
  - ③ Press slide plate safety lock to release slide plate.
3. Mount the camera to the slide plate.

Align the camera screw and video boss with the camera, and tighten camera screw securely.
4. Mount camera and slide plate to the tripod head.
  - ① With camera mounted, insert slide plate back into the tripod head.
  - ② Tighten slide plate lock lever securely, for final step.
5. Loosen the ball leveler fixing handle, adjust head using the bubble level, and tighten the ball leveler fixing handle securely.



# Further Information

**For more information on products listed in this manual, visit us online:**

**[www.acebil.com](http://www.acebil.com)**

**or contact us at:**

**Eagle Beaming International Co. LTD.  
No. 53 Hoping Rd. Luchou District  
New Taipei City, 24750 Taiwan**

**TEL: (02)28479387**

**Eagle America Sales Corporation  
Acebil  
2517 W 237th Street, Unit C  
Torrance, CA 90505**

**TEL: (310) 257-8886**

**To view our full line of Acebil camera support equipment, visit us online:**

**[www.acebil.com](http://www.acebil.com)**